

HardieFlex™ sheet

A smooth, flat sheet that is painted on-site to create a flat panel look.

Where do you use it?

As an external wall cladding, eaves or soffit lining in residential single and medium-density homes, including alterations and additions, where a flat panel look is required. Ideal for full wrap or composite construction designs on either timber or light gauge steel framed homes.

What are the key benefits?

Affordability.

Fast installation involving only two trades helps make HardieFlex™ sheet one of the most cost-effective cladding solutions available.

Design flexibility.

It's easy to achieve a range of looks with HardieFlex™ sheet using battens or Scyon™ Axent™ trim vertically over sheet joints, as bold or subtle highlights over their smooth, flat surface.

Fast installation.

HardieFlex™ sheet is lightweight and its square edges, together with the wide range of James Hardie™ accessories, make it easy and fast to install by tradespeople, owner-builders and renovators.

Versatility.

6mm HardieFlex™ base sheet can also be used as bracing.*

Security.

HardieFlex™ sheet is resistant to damage from termites, rot and fire.
A 10-year product warranty gives peace of mind.

Available sizes

Length (mm)	Width (mm)	Thickness (mm)	Mass (kg/m ²)				
1800	900	4.5	7.7				
2400							
2700							
3000							
1800	1200			4.5	7.7		
2100							
2400							
2700							
3000	1200					6	10
2400							
3000							
1800							
2400	900	6	10				
3000							
1800							
2400							
2700	1200			6	10		
3000							
1800							
2400							
2700	1200					6	10
3000							
1800							
2400							

Timber batten joint

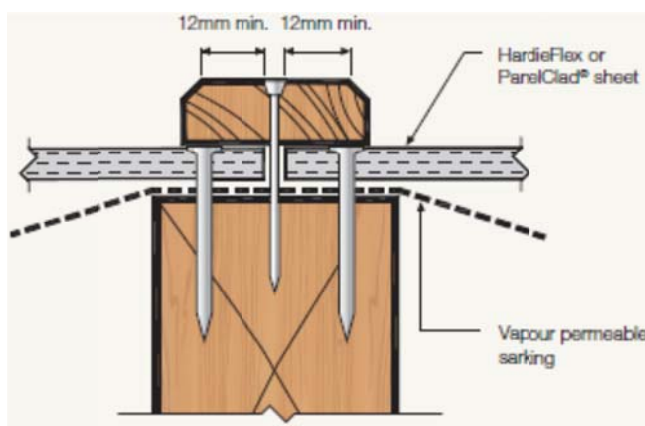

Accessories

James Hardie™ PVC Straight Jointer

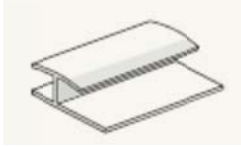

A PVC extrusion used to join sheets.

Length: 3000mm x 4.5mm
3000mm x 6.0mm

James Hardie™ 45x45mm PVC Corner Angle Mould

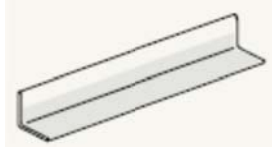

A PVC extrusion used to finish internal and external corners.

Length: 3000mm

James Hardie™ PVC Cap Mould

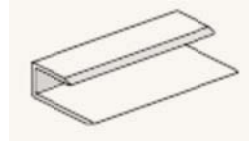

A PVC extrusion used to finish sheet edges.

Length: 3000mm x 4.5mm
3000mm x 6.0mm

James Hardie™ PVC Flashing Mould for 6mm thick sheets



A PVC extrusion for multicourse fixing of 6mm thick sheets.

Length: 3000mm

James Hardie™ PVC Internal Corner Angle for 6mm thick sheets

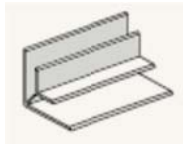

A PVC extrusion, to be used with 6mm thick sheets at internal corner junctions to conceal the sheet edge.

Length: 3000mm

James Hardie™ PVC External Corner Angle for 6mm thick sheets

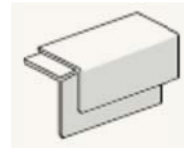

A PVC extrusion, to be used with 6mm thick sheets at external corner junctions to conceal the sheet edge.

Length: 3000mm

James Hardie™ Fibreshears

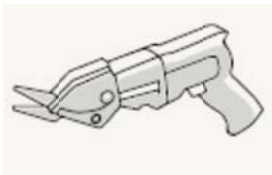

Electric tool for cutting fibre cement sheets.

HardieBlade™ Saw Blade

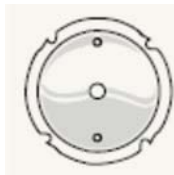

A 185mm or 254mm diameter poly-diamond blade for fast and clean cutting of James Hardie fibre cement

James Hardie™ Score and Snap Knife



A tungsten tipped knife for scoring fibre cement sheets.